



FUEL TANK OVERPRESSURE CHECK VALVE LUN 7466.81

The fuel tank overpressure check valve LUN 7466 is 2/2 way check valve of poppet design. This valve protects A/C integral fuel tanks from overpressure. If the pressure drop between the fuel tank and ambient air rise over defined limit, the valve drains the air from the fuel tank to the ambient atmosphere.



SPECIFICATION

LUN 7466.81

Weight:	max. 0,06 kg
Temperature range:	operating -55 °C to +70 °C non-operating -55 °C to +85 °C
Fluid temperature:	-55 °C to +60 °C
Operating height range:	from 0 to 35 000 ft (10 700 m)
Cracking overpressure:	12 - 14,7 kPa
Fluid:	kerosene based fuels

DIMENSIONS

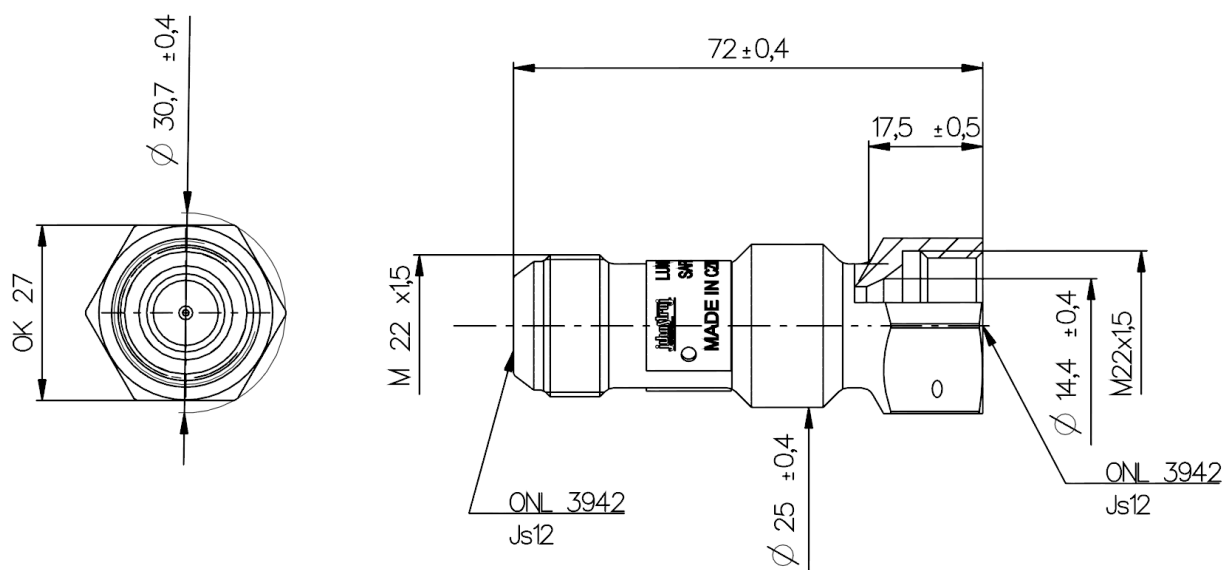

Data stated in this datasheet are for information purposes only, and are not subject to change. Specific installation dimensions can be agreed with customer for given installation.